



# SAKURA-CON 2023

April 7 - 9, Seattle Convention Center  
900 Pine Street • Seattle, WA 98101 • U.S.A.

## Convention Site Map and Floor Plans

April 6 revision

### Area Map, Downtown Seattle

Note that all **Registration** is in the Summit Building, Level 2.

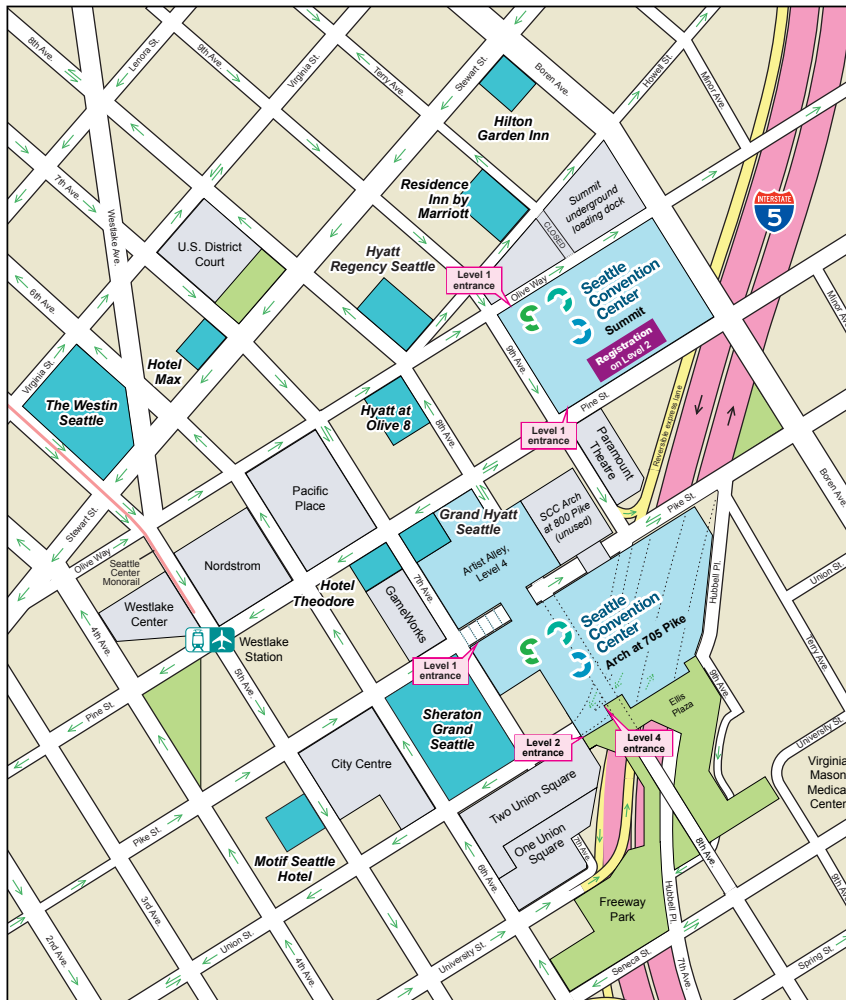

 Sakura-Con affiliated hotels

 One-way street

 Two-way traffic begins/ends

The Washington State Convention Center has changed its name to **Seattle Convention Center**. The main convention space for Sakura-Con 2023 is the SCC's new **Summit Building** at 900 Pine St.

The original Convention Center building is now called **Arch at 705 Pike**. Level 2 and all but one room of Level 3 are not used by Sakura-Con 2023. The Conference Center is now called Arch at 800 Pike, but this building is also unused.

 Sound Transit Link Light Rail station

Light rail provides rapid transit between downtown Seattle and Sea-Tac Airport with a travel time of approximately 38 minutes. For fares, schedules and complete details, see [www.soundtransit.org](http://www.soundtransit.org).

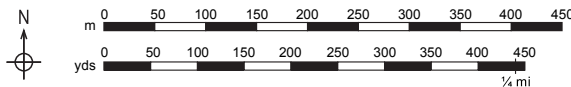

# Summit Level EX (Lower Level)



# Summit Level 1

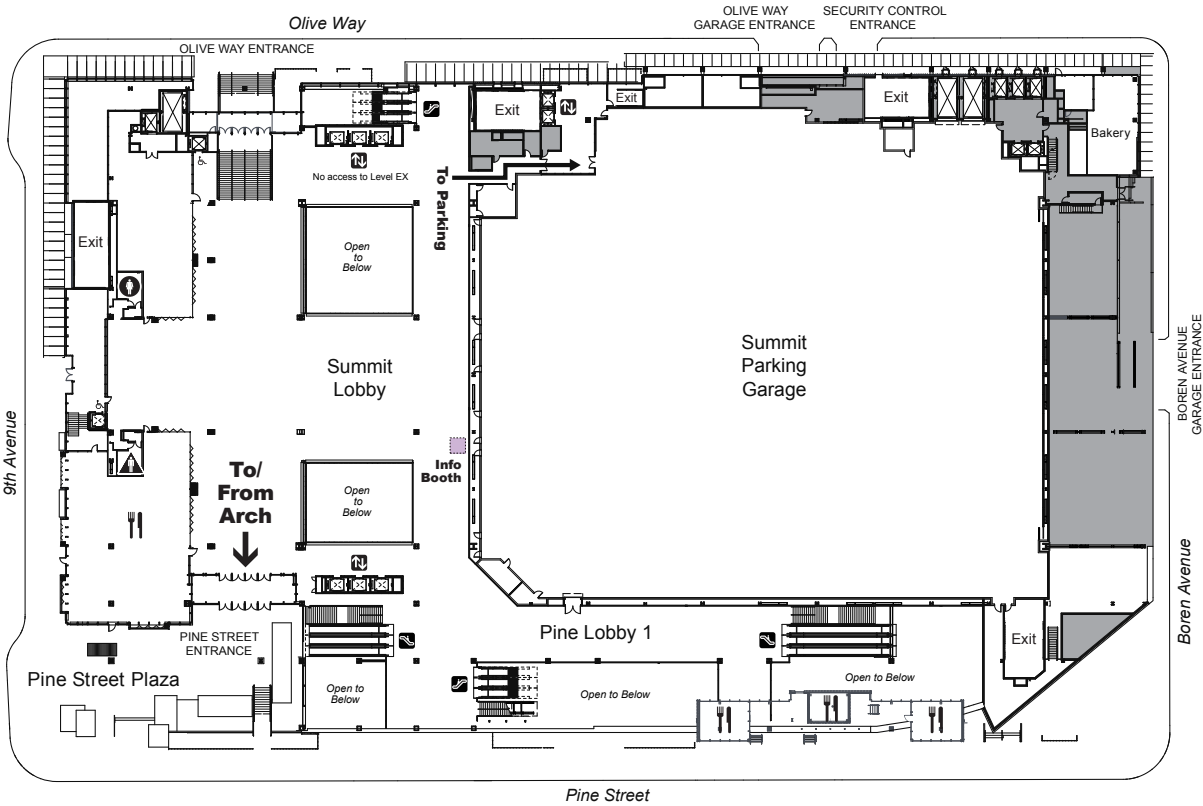
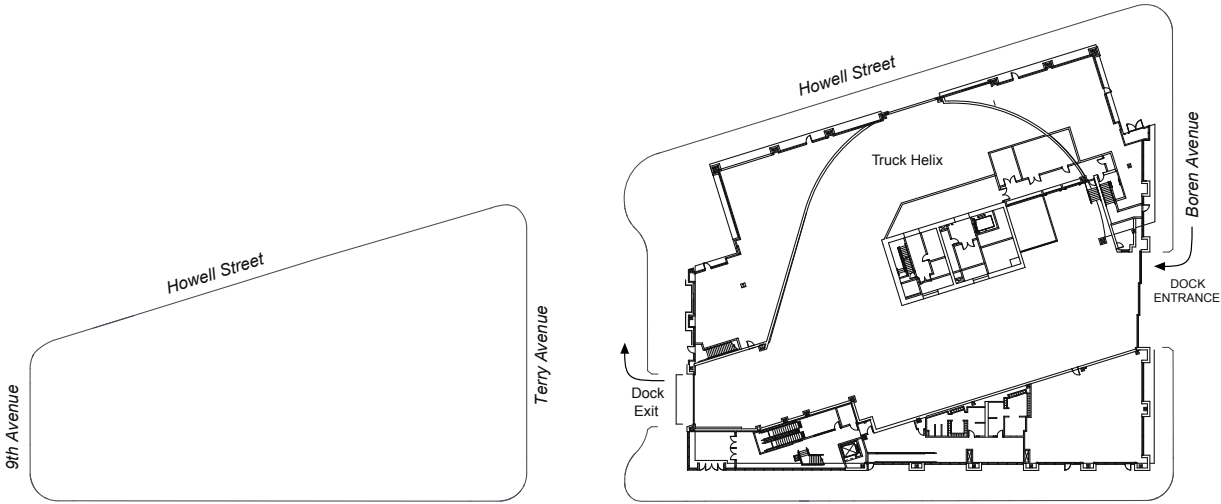

# Summit Level 2

## Registration

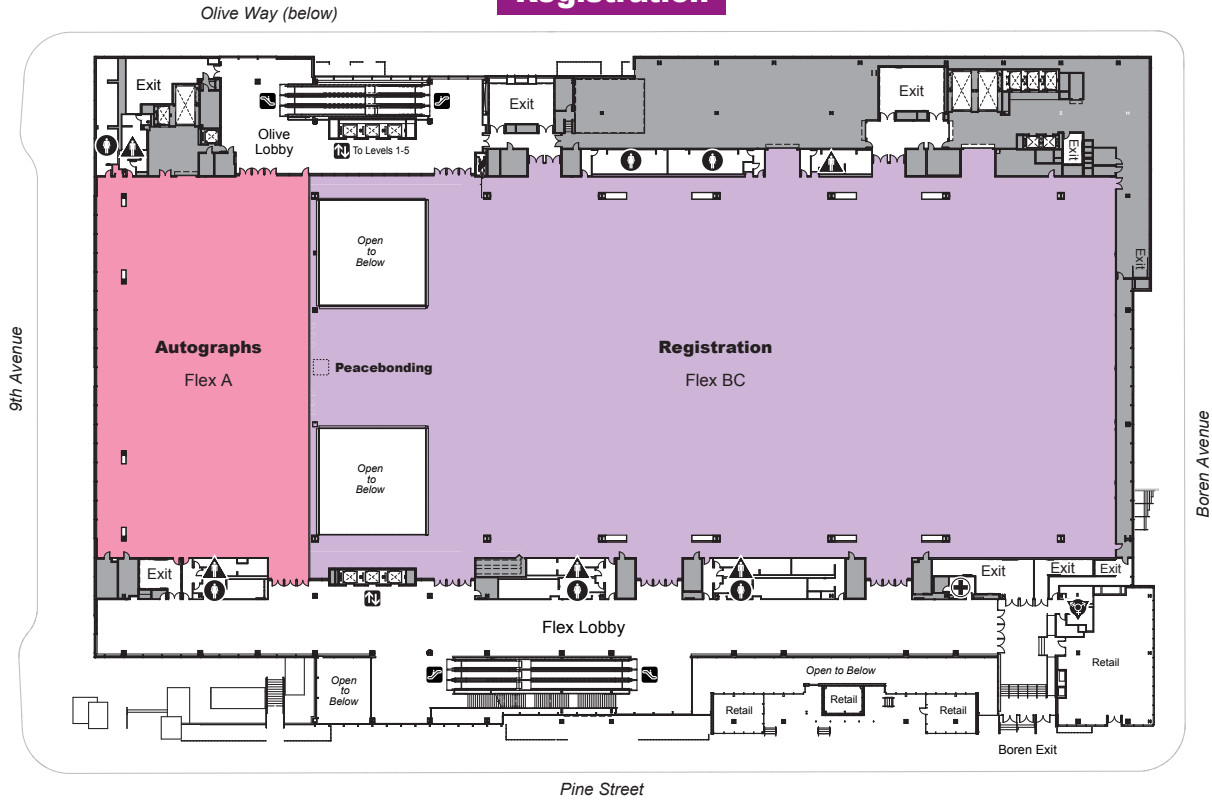

# Summit Level 3

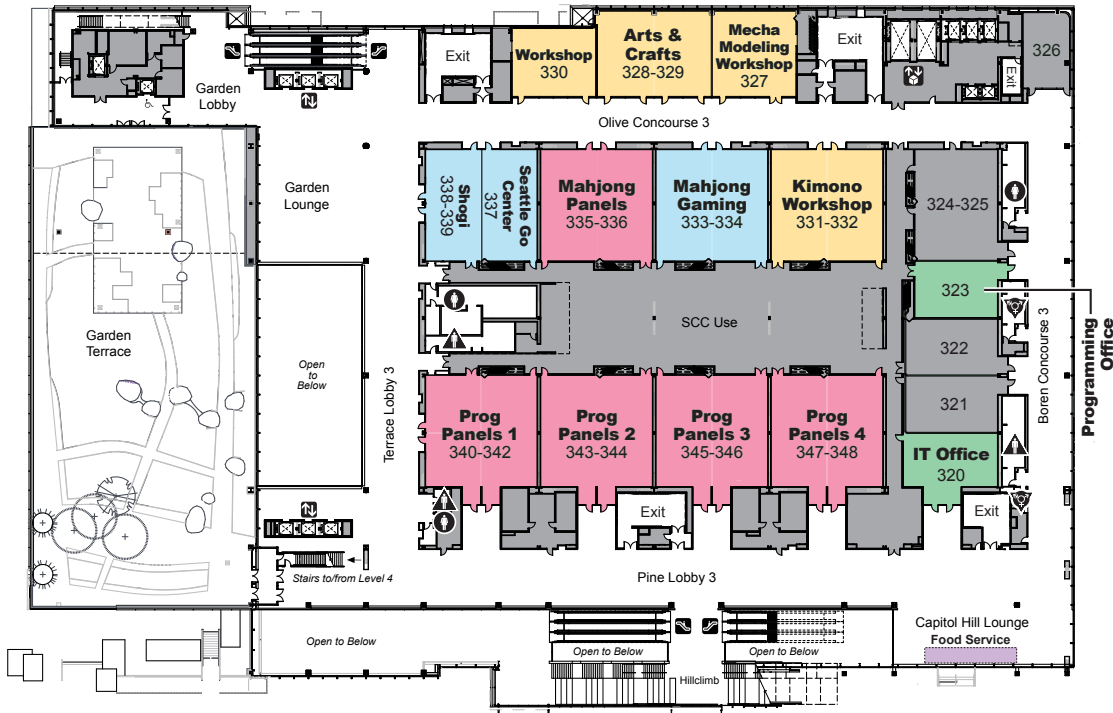





## Arch at 705 Pike Level 6



## Arch at 705 Pike Level 3

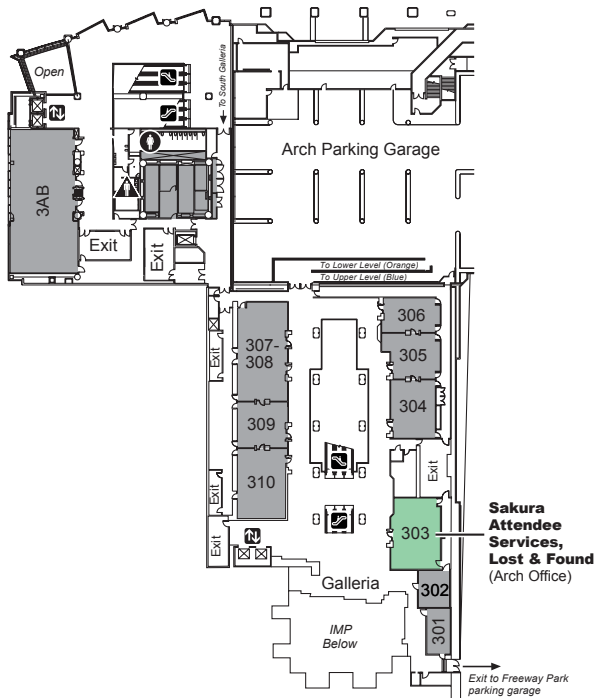

## Legend

- Event and Panel Rooms
- Video Theaters
- Merchandise and Services
- Workshops, Arts and Crafts
- Video Gaming
- Tabletop Gaming
- Sakura-Con offices
- Rooms not accessible by attendees
- ♂ Men's restrooms
- ♀ Women's restrooms
- ♿ Gender-neutral restrooms
- ↕ Escalators to level above/below
- N Elevators accessible by attendees
- + First Aid Stations